

ORA

Order Code	Product Code	Description
20590	ORA-300-W-WW	15W LED Oyster, White Trim, Warm White 3000K
20591	ORA-300-W-W	15W LED Oyster, White Trim, White 5000K
20592	ORA-300-S-WW	15W LED Oyster, Satin Chrome Trim, Warm White 3000K
20593	ORA-300-S-W	15W LED Oyster, Satin Chrome Trim, White 5000K
20594	ORA-350-W-WW	25W LED Oyster, White Trim, Warm White 3000K
20595	ORA-350-W-W	25W LED Oyster, White Trim, White 5000K
20596	ORA-350-S-WW	25W LED Oyster, Satin Chrome Trim, Warm White 3000K
20597	ORA-350-S-W	25W LED Oyster, Satin Chrome Trim, White 5000K

Thank you for purchasing your new LED ORA oyster light, Please take the time to read and understand the instruction sheet below. Failure to do so may void warranty.

ORA-300 Specifications

Voltage:	240V AC	Lumen (±5%):	Warm White 3000K - 960lm White 5000K - 1080lm	Dimmable:	Yes**
Power:	15W	Beam Angle:	120°	CCT:	3000K - 5000K
IP Rating:	44	Lifespan (hrs):	50,000hrs	CRI:	≥80

ORA-350 Specifications

Voltage:	240V AC	Lumen (±5%):	Warm White 3000K - 1340lm White 5000K - 1500lm	Dimmable:	Yes**
Power:	25W	Beam Angle:	120°	CCT:	3000K - 5000K
IP Rating:	44	Lifespan (hrs):	50,000hrs	CRI:	≥80

1. Take out ceiling light and accessories.

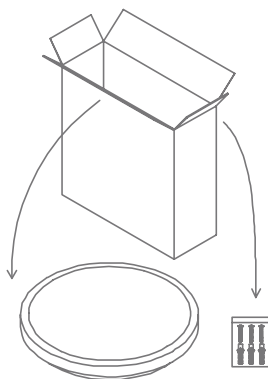

2. Fix wall plugs onto the ceiling.

(Please use correct type for the appropriate ceiling type)

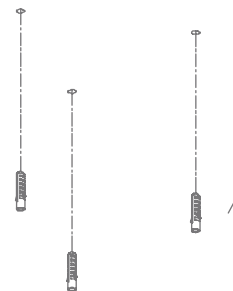

Note: -The lamp must be installed by professional electrician
-Ensure the power supply is switched off before fitting this product

-Do not touch the lamp when in use
-Keep away from hot steam and corrosive gas

Installation Manual

1. Rotate the diffuser to disengage from base plate.

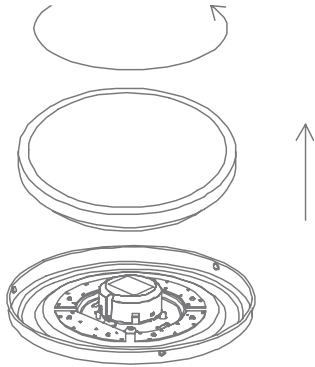



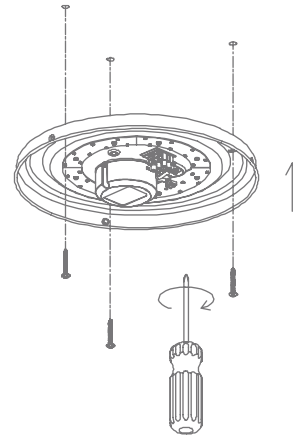

2. Screw the base plate on the ceiling.

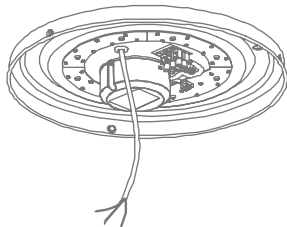

3. Connect the wire to terminal at base plate, and ensure correct connection is made. Replace terminal block cover.



-  L = Brown
-  N = Blue
-   = Yellow-Green

4. Rotate the lampshade as indicated by the arrows to fix it to base plate.

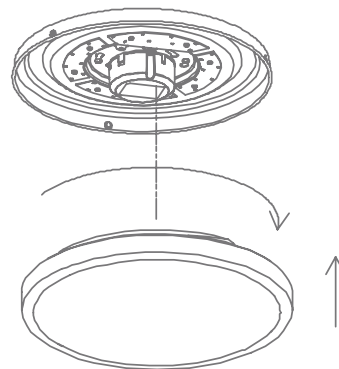

5. Test by using ON/OFF switch or control dimmer.

