

Step Light

Magnetic COB LED Step Light Series

A series of luminaires carry out multitask in different application. Using reliable tri color COB can achieve tri color from 3000-4000-5000K and remain a good lighting ambience in this mini luminaire. Enjoy feasibility from mini size driver with dimming capability. IP54 rated structure and anti-rusty AkzoNobel powder coating make the fitting moisture friendly for long period duration.



EVERCORE COB LED

LED

- Tri color 3000K-4000K-5000K
- Remain consistency of lighting performance

Driver

2 ways to flexibly place the driver.
Attach the driver on the heatsink with snap joint design or separate it from the heatsink.
Phase Cut dimmable
5-year warranty

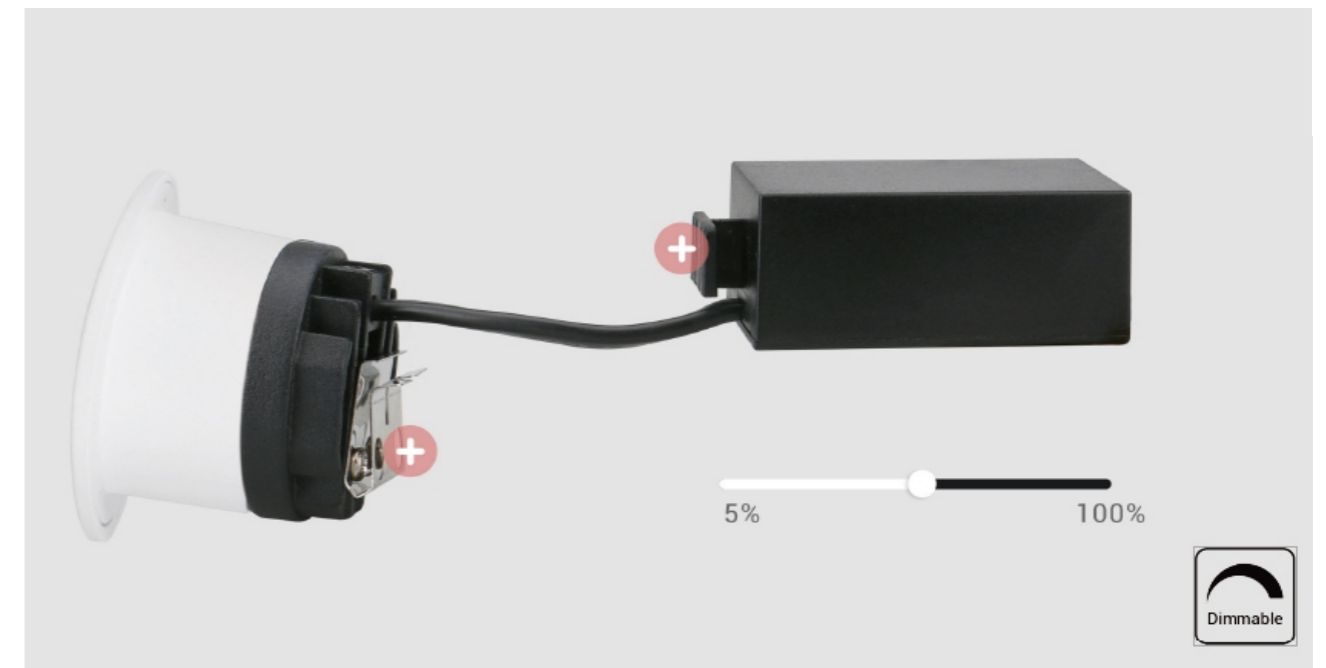

Magnetic Design

Interchangeable faceplates
Square / Round / Slot / Smiling
White / Black / Brushed Chrome

Step Light

Black
White
Satin Chrome
(Made to Order)

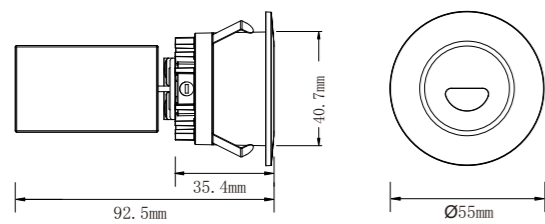

Cut-out: Ø45mm

UOW-VOGUE-BLK-3CCT UOW-VOGUE-WH-3CCT

Technical Data

Input Voltage/Hz	AC200-240V 50Hz
Output Voltage/Current	DC33V/60mA
Power	3W
Rated Input Current	0.015A
THD	<30%
PF value	>0.82
Ingress Protection	IP54
Operating Temperature	-10—40°C
Dimmability	Phase Cut dimmable with DIMMATE driver

Optical Data

LED Brand	EVERCORE COB LED
CRI	Ra>90
Colour temperatures	3000K-4000K-5000K
System luminous efficacy up to	12lm/W

Black
White
Satin Chrome
(Made to Order)

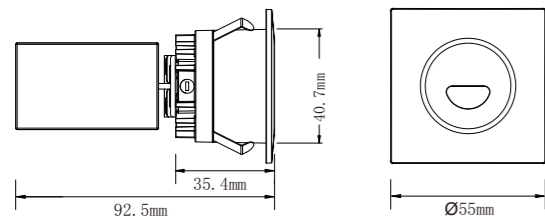

Cut-out: Ø45mm

UOW-JAZZ-BLK-3CCT UOW-JAZZ-WH-3CCT

Technical Data

Input Voltage/Hz	AC200-240V 50Hz
Output Voltage/Current	DC33V/60mA
Power	3W
Rated Input Current	0.015A
THD	<30%
PF value	>0.82
Ingress Protection	IP54
Operating Temperature	-10—40°C
Dimmability	Phase Cut dimmable with DIMMATE driver

Optical Data

LED Brand	EVERCORE COB LED
CRI	Ra>90
Colour temperatures	3000K-4000K-5000K
System luminous efficacy up to	12lm/W

FEATURES

- Made of die-casting.
- Powder coating finish from AkzoNobel.
- Interchangeable faceplate with magnetic design.
- High density COB with uniform lighting distribution.
- Compatible with leading and trailing edge phase cut dimmers.
- 5-year warranty.

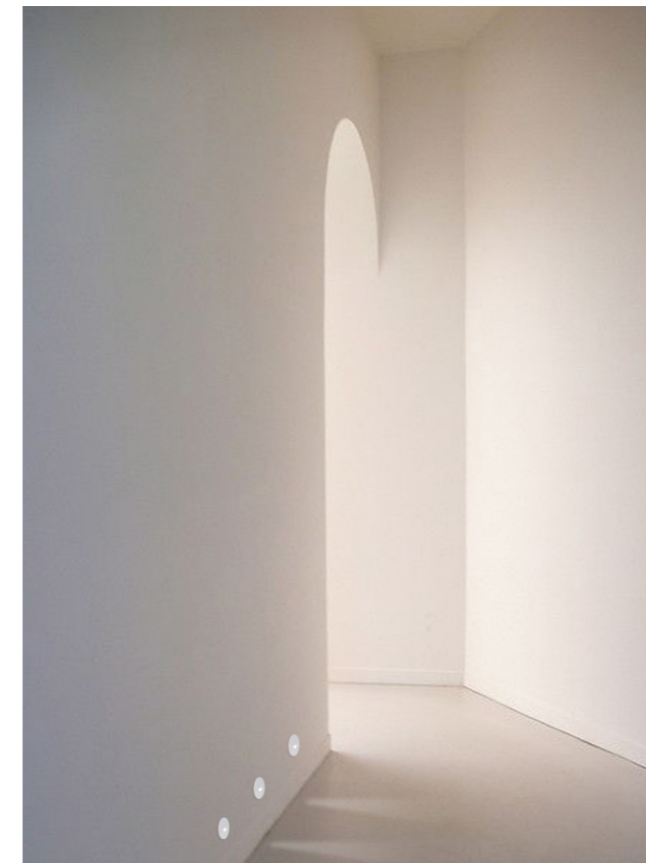

Step Light

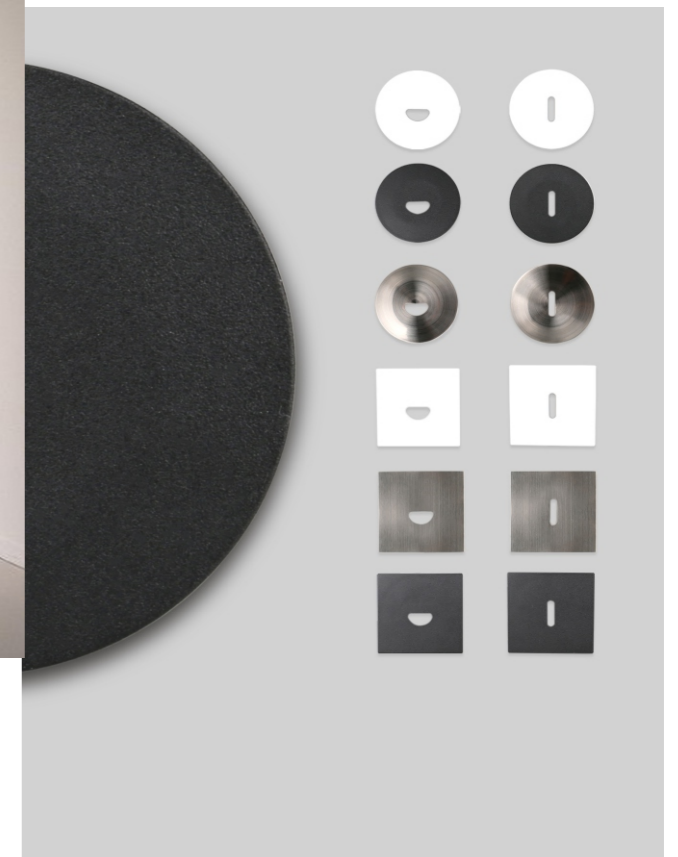

to suit multiple interior Interchangeable faceplate design needs.