

LED track light --Dot series

Data Sheet



UMAG-DOT6

UMAG-DOT12

DESCRIPTION

Magnetic Dot light made of aluminum
 Easy to install/move/replace by hand, no need any tools.
 High energy efficient LED with high CRI
 Deep anti-glare cut-off angle, light soft & average
 Power range: 1W/4W/8W/16W
 Phase cut/0-10V main dimmable/ DALI dimmable option

TECHNICAL DRAWINGS

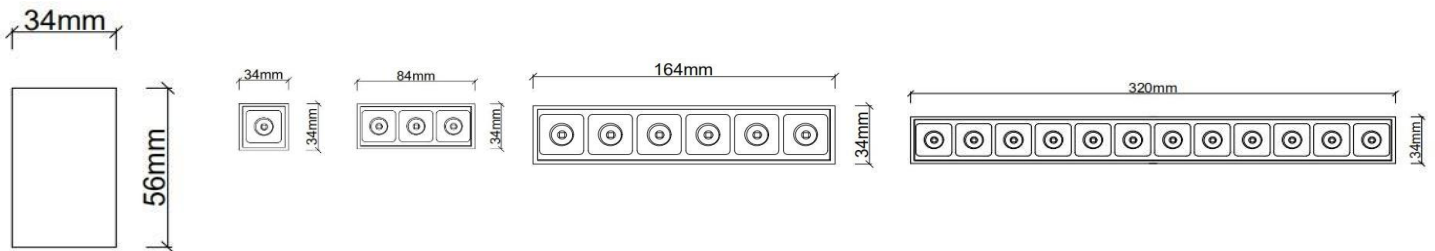

SPECIFICATION

Model no.	Power	Lumen	CCT	Beam	CRI(Ra)	Source	Dim	Color	Volt	Dimension(LxWxH)(mm)
UMAG-DOT1	1W	60lm	3000K	12/34/48D	>90	Osram	No	Sandy Black /White	24V	34*34*55.5
UMAG-DOT3	4w	240	3000K	12/34/48D	>90	Osram	Yes	Sandy Black /White	24V	83.5*34*55.5
UMAG-DOT6	8w	520	3000K	12/34/48D	>90	Osram	Yes	Sandy Black /White	24V	163*34*55.5
UMAG-DOT12	16w	1020	3000K	12/34/48D	>90	Osram	Yes	Sandy Black /White	24V	322*34*55.5

Dot1 and Dot3 are available upon request

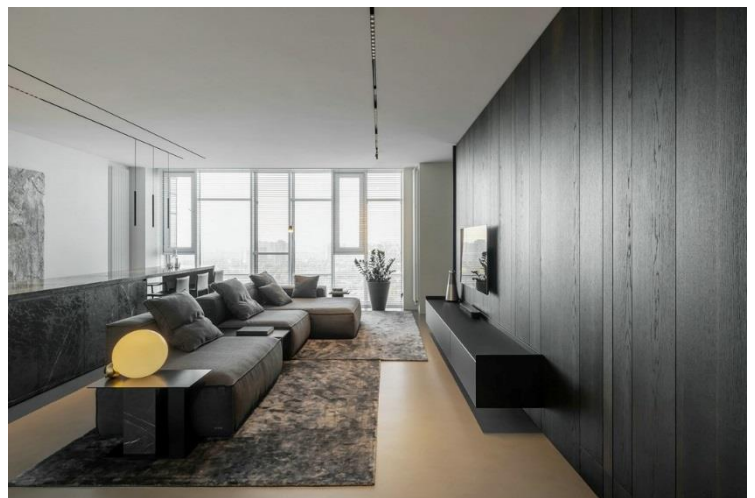

LED track light --Spot series

Data Sheet



UMAG-SPOT2x5



UMAG-SPOT12



UMAG-SPOT20

DESCRIPTION

Magnetic spot light made of aluminum

Easy to install/move/replace by hand, no need any tools.

COB LED with maximum efficiency, no multiple shadows, high CRI

CCT: 2700-6500k

Deep anti-glare cut-off angle, light soft & average Power range: 5W/8W/10W/15W

TECHNICAL DRAWING

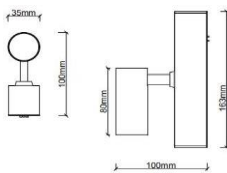

UMAG-SPOT5

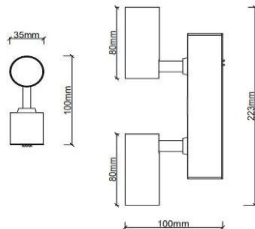

UMAG-SPOT2x5

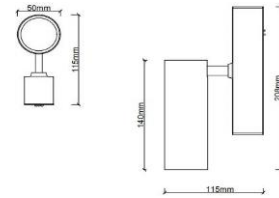

UMAG-SPOT12

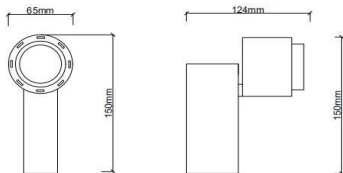

UMAG-SPOT8

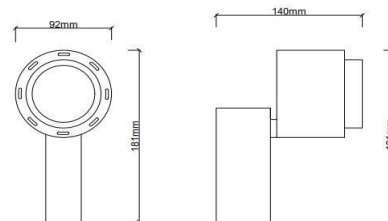

UMAG-SPOT15

Model no.	Power	Lumen	CCT	Beam	CRI(Ra)	Source	Dim	Color	Volt	Dimension(L*W*H)(mm)
UMAG-SPOT5	5w	360lm	3000K	20/30/40/60D	>80	Cree	Yes	Sandy Black/White	24V	Ø35*80*163
UMAG-SPOT2x5	2x5W	720lm	3000K	20/30/40/60D	>80	Cree	Yes	Sandy Black/White	24V	Ø35*80*223
UMAG-SPOT12	10W	870lm	3000K	18/24/36D	>80	Cree	Yes	Sandy Black/White	24V	Ø50*140*208
UMAG-SPOT8	8W	395lm	3000K	10/20/30D	>80	Cree	Yes	Sandy Black/White	24V	Ø62*65*150
UMAG-SPOT15	15W	822lm	3000K	10/20/30D	>80	Cree	Yes	Sandy Black/White	24V	Ø92*82*181

Spot5 , Spot10 are available upon request

LED track light --Pendant series

Data Sheet

DESCRIPTION:



UMAG-PENDANT10

UMAG-PENDANT5

Magnetic pendant light made of aluminium
 Easy to install/move/replace by hand, no need any tools.
 COB LED with maximum efficiency, no multiple shadows, high CRI
 CCT: 2700-6500k
 Deep anti-glare cut-off angle, light soft & average Power range: 5W/10W
 Non dimmable/0-10V main dimmable/ DALI dimmable option

TECHNICAL DRAWINGS

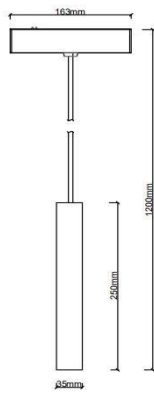

UMAG-PENDANT5

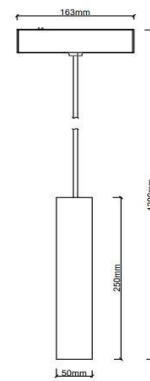

UMAG-PENDANT10

SPECIFIC

Model no.	Power	Lumen	CCT		Beam	CRI(Ra)	Source	Dim	Color	Volt	Dimension(L*W*H)(mm)
UMAG-Pendant10	10W	870lm	3000K		18/24/36 D	>80	Cree	Yes/NO	Sandy Black /White	24V	Ø50*250
UMAG-Pendant5	5W	320	3000K		18/24/36 D	>80	Cree	Yes/NO	Sandy Black /White	24V	Ø35*250

LED TRACK LIGHT—GLOBAL SERIE

Data Sheet



UMAG-GLOBAL

DESCRIPTION

Global made by glass

Easy to install/move/replace by hand, no need any tools.

COB LED with maximum efficiency, high CRI CCT: 2700-6500k

Deep anti-glare cut-off angle, light soft & average Power range: 5W/10W

Non dimmable/0-10V main dimmable/ DALI dimmable option

Technical Drawing

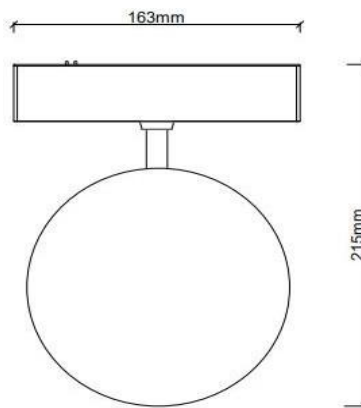

Specification

Model no.	Power	Lumen	CCT	Beam	CRI(Ra)	Source	Dim	Color	Volt	Dimension(L*W*H)(mm)
UMAG-Global	5W	400lm	3000K	/	>80	Osram	Yes/NO	Sandy Black /White	24V	Ø150

Data Sheet



DESCRIPTION

UMAG-BALANCE Magnetic linear light made of aluminium
 Flush with profile system; completely homogeneously illuminated, satinised PMMA cover;
 Easy to install/move/replace by hand, no need any tools.
 Energy-efficient high power LEDs with very good colour rendering, high CRI
 CCT: 2700-6500k
 0-10V main dimmable/ DALI dimmable option

TECHNICAL DRAWINGS

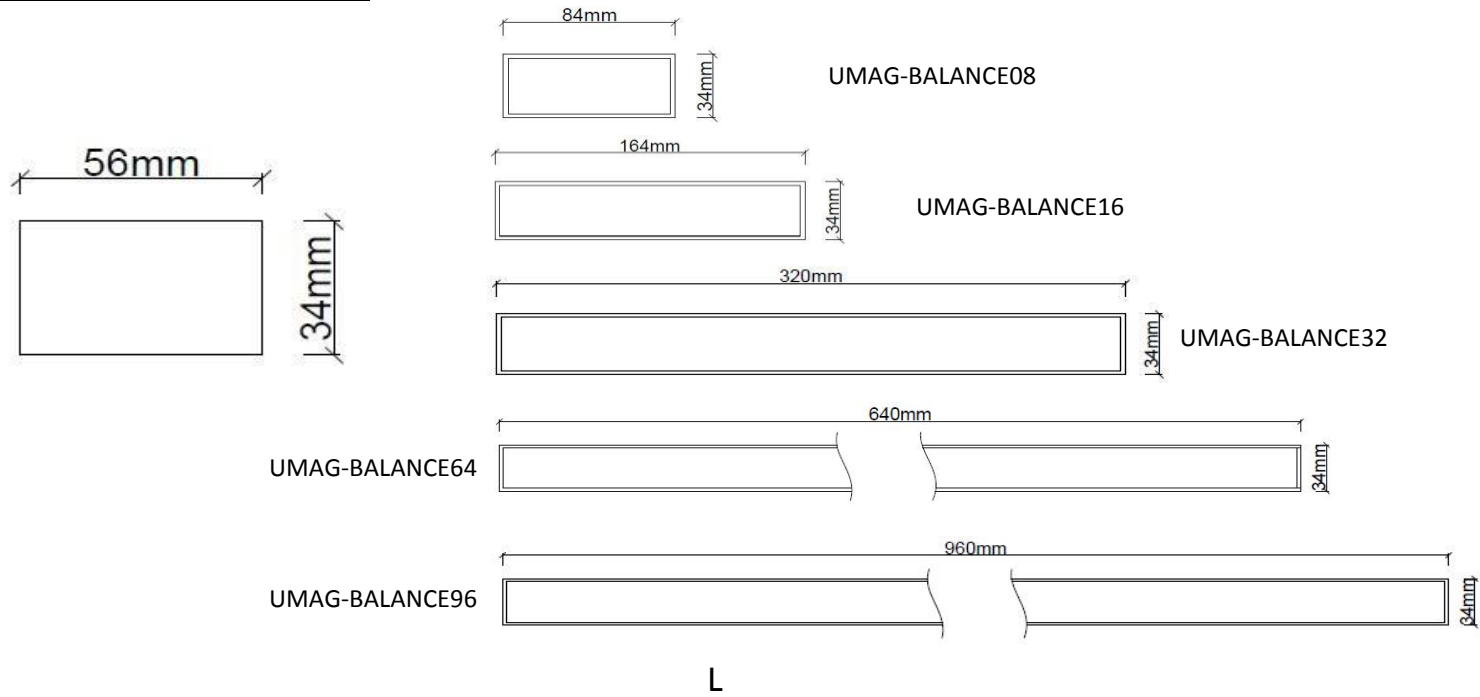

SPECIFICATION

Model no.	Power	Lumen	CCT	Beam	CRI(Ra)	Source	Dim	Color	Volt	Dimension(L*W*H)(mm)
UMAG-BALANCE8	4W	240lm	3000K	diffuse	Ra80/90	Osram	Yes	Sandy Black/White	24V	83.5*34*55.5
UMAG-BALANCE16	7W	420	3000K	diffuse	Ra80/90	Osram	Yes	Sandy Black/White	24V	163*34*55.5
UMAG-BALANCE32	13w	660	3000K	diffuse	Ra80/90	Osram	Yes	Sandy Black/White	24V	322*34*55.5
UMAG-BALANCE64	26w	1400	3000K	diffuse	Ra80/90	Osram	Yes	Sandy Black/White	24V	640*34*55.5
UMAG-BALANCE96	39w	1620	3000K	diffuse	Ra80/90	Osram	Yes	Sandy Black/White	24V	958*34*55.5

LED track light --Fold series

Data Sheet



UMAG-SCOOP3

DESCRIPTION

Magnetic fold light made of aluminium

Fold design, light angle adjustable

Easy to install/move/replace by hand, no need any tools.

Energy-efficient high power LEDs with very good colour rendering, high CRI

CCT: 2700-6500k

0-10V main dimmable/ DALI dimmable option



UMAG-SCOOP6



UMAG-SCOOP12

UMAG-SCOOP08

UMAG-SCOOP16

UMAG-SCOOP32

IP20

TECHNICAL DRAWINGS

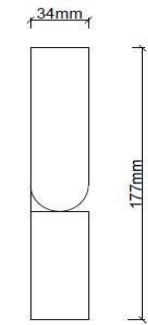

W*H

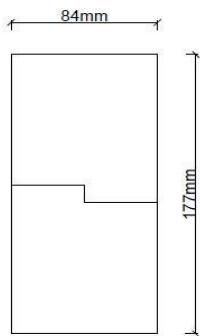

UMAG-SCOOP3
UMAG-SCOOP08

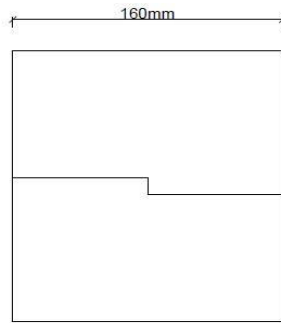

UMAG-SCOOP6
UMAG-SCOOP16

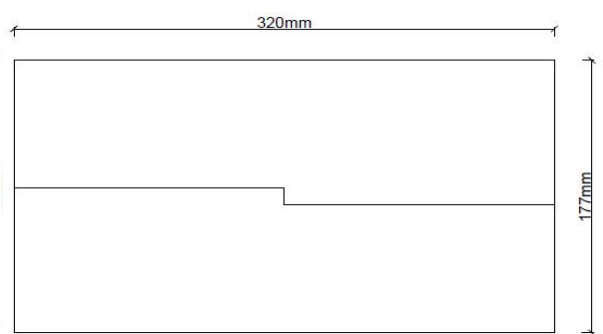

UMAG-SCOOP12
UMAG-SCOOP32

SPECIFICATION

Model no.	Power	Lumen	CCT	Beam	CRI	Source	Dim	Color	Volt	Dimension(L*W*H)(mm)
UMAG-SCOOP3	4w	240	3000K	12/34/48 D	Ra80/90	Osram	Yes	Sandy Black/White	24V	84*34*181
UMAG-SCOOP6	8w	520	3000K	12/34/48 D	Ra80/90	Osram	Yes	Sandy Black/White	24V	163.5*34*181
UMAG-SCOOP12	16w	1020	3000K	12/34/48 D	Ra80/90	Osram	Yes	Sandy Black/White	24V	322.5*34*181
UMAG-SCOOP08	4W	240lm	3000K	diffuse	Ra80/90	Osram	Yes	Sandy Black/White	24V	84*34*181
UMAG-SCOOP16	7W	420	3000K	diffuse	Ra80/90	Osram	Yes	Sandy Black/White	24V	163.5*34*181
UMAG-SCOOP32	13w	660	3000K	diffuse	Ra80/90	Osram	Yes	Sandy Black/White	24V	322.5*34*181

Data Sheet

DESCRIPTION

UMAG-Out12

Magnetic out light made of aluminium
 Easy to install/move/replace by hand, no need any tools.
 Energy-efficient high power LEDs with very good colour rendering, high CRI
 CCT: 2700-6500k
 0-10V main dimmable/ DALI dimmable option

UMAG-Out32

TECHNICAL DRAWINGS

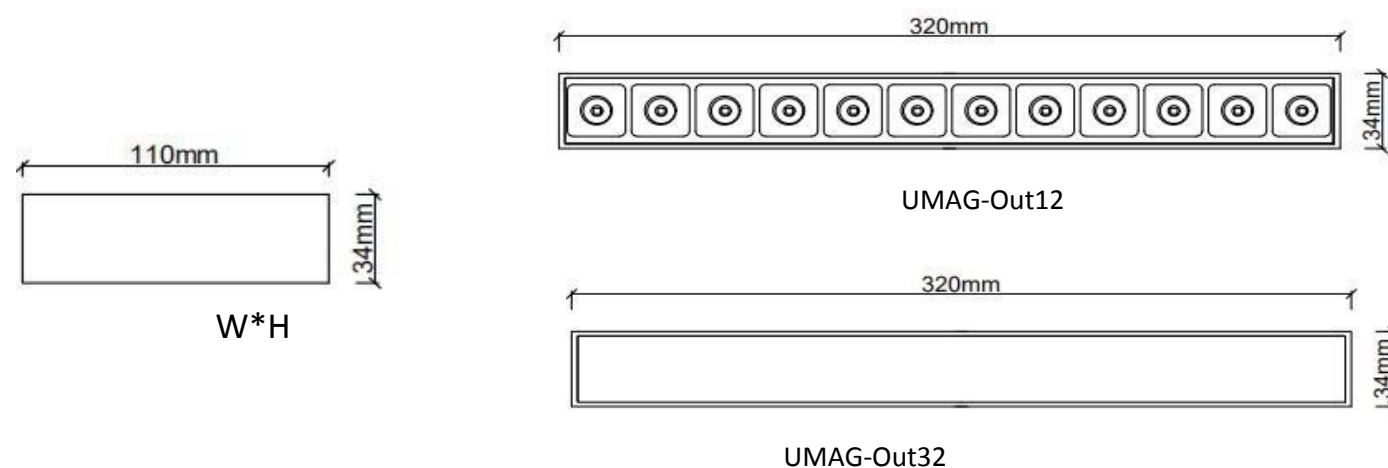

SPECIFICATION

Model no.	Power	Lumen	CCT	Beam	CRI(Ra)	Source	Dim	Color	Volt	Dimension(L*W*H)(mm)
UMAG-Out12	16W	1280	3000K	12/34/48 D	Ra80/90	Osram	Yes	Sandy Black/White	24V	320*34*110
UMAG-Out32	13W	780	3000K	diffuse	Ra80/90	Osram	Yes	Sandy Black/White	24V	320*34*110

Notes

Working Temp.: -30 to +70°C (Refer to "Derating Curve")

Working Humidity: 20 ~ 95% RH non-condensing

LED track light --Wallwasher series

Data Sheet

UMAG-Washer13 **DESCRIPTION**

Magnetic Wallwasher made of aluminium
 Flush with profile system; completely homogeneously illuminated, satinised PMMA cover;
 Easy to install/move/replace by hand, no need any tools.

UMAG-Washer27 Energy-efficient high power LEDs with very good colour rendering, high CRI
 CCT: 2700-6500k
 0-10V main dimmable/ DALI dimmable option

IP20

TECHNICAL DRAWINGS

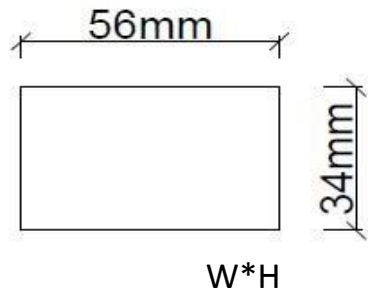

UMAG-Washer13



UMAG-Washer27

SPECIFICATION

Model no.	Power	Lumen	CCT	Beam	CRI(Ra)	Source	Dim	Color	Volt	Dimension(L*W*H)(mm)
UMAG-Washer13	8W	480	3000K	wallwasher	Ra80/90	Osram	Yes	Sandy Black/White	24V	138*34*56
UMAG-Washer27	16W	960	3000K	wallwasher	Ra80/90	Osram	Yes	Sandy Black/White	24V	270*34*56

Notes

Working Temp.: -30 to +70°C (Refer to "Derating Curve")

Working Humidity: 20 ~ 95% RH non-condensing

Data Sheet

DESCRIPTION

24V profile for vertical and horizontal installation in plasterboard ceiling
1/2/3 meter profile option
Customizable dimensions available.



For recessed/surface/pendant installation.
IP20

particually for recessed installation.

TECHNICAL DRAWINGS

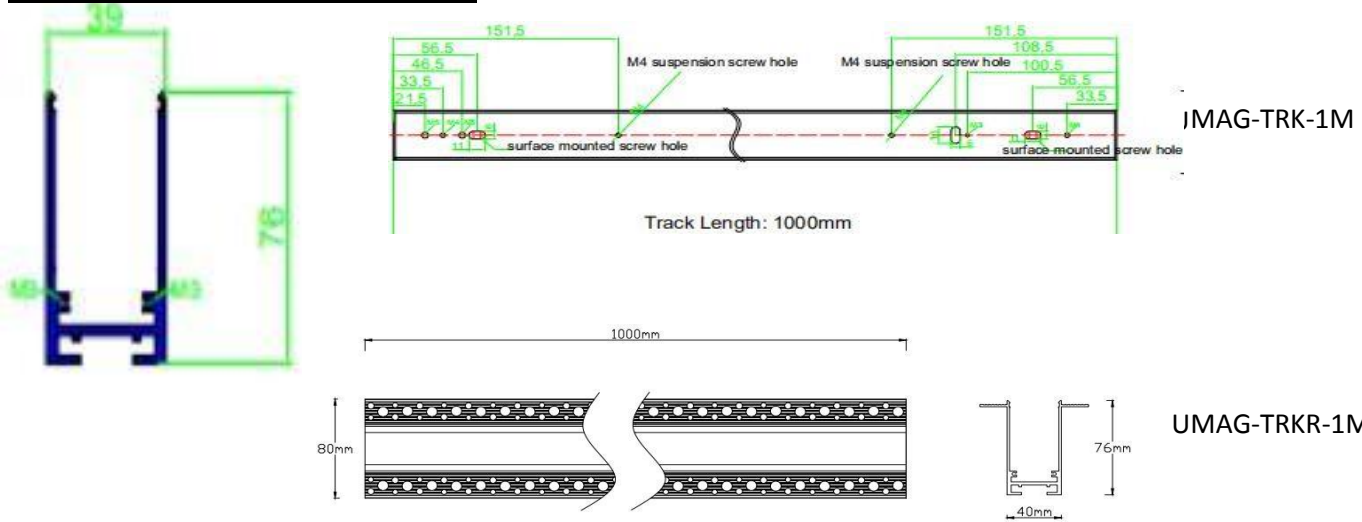

SPECIFICATION

Model no.	Power	Lumen	CCT	Beam	CRI(Ra)	Dim	Color	Volt	Dimension(L*W*H)(mm)
UMAG-TRK-1M	200w Max	/	/	/	/	Yes	Sandy Black/White	24V	1000*39*76
UMAG-TRK-2M	200w Max	/	/	/	/	Yes	Sandy Black/White	24V	2000*39*76
UMAG-TRK-3M	200w Max	/	/	/	/	Yes	Sandy Black/White	24V	3000*39*76
UMAG-TRKR-1M	200w Max	/	/	/	/	Yes	Sandy Black/White	24V	1000*39*76
UMAG-TRKR-2M	200w Max	/	/	/	/	Yes	Sandy Black/White	24V	2000*39*76
UMAG-TRKR-3M	200w Max	/	/	/	/	Yes	Sandy Black/White	24V	3000*39*76

Data Sheet

DESCRIPTION

Extensive assortment of angle connectors for maximum system flexibility



L Corner



Inner Corner



Outer Corner



Cross corner



45D corner



T corner

IP20

TECHNICAL DRAWINGS

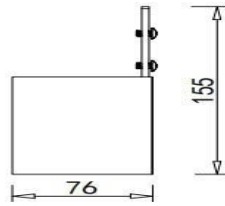
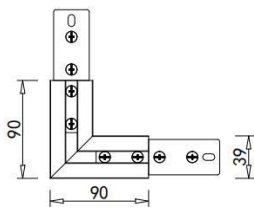

L corner

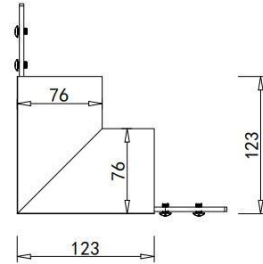
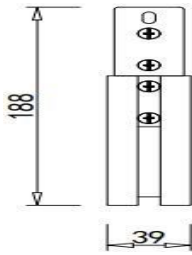

Inner corner

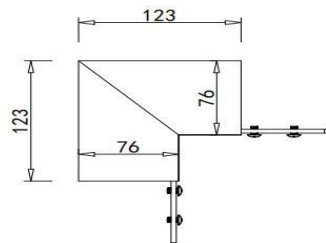
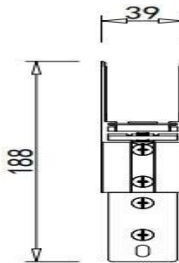

Outer corner

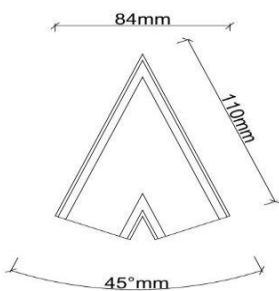

45D corner

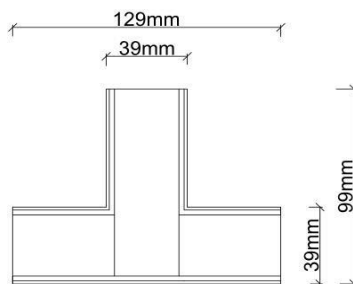

T corner

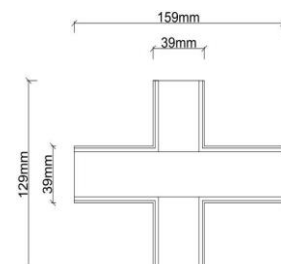

Cross

LED track light --Corner-R



LIGHTING THAT OUTPERFORMS
SINCE 1998

Data Sheet

DESCRIPTION

Extensive assortment of angle connectors for maximum system flexibility particularly for recessed installation.



L Corner-R



Inner Corner-R



Outer Corner-R

IP20

TECHNICAL DRAWINGS

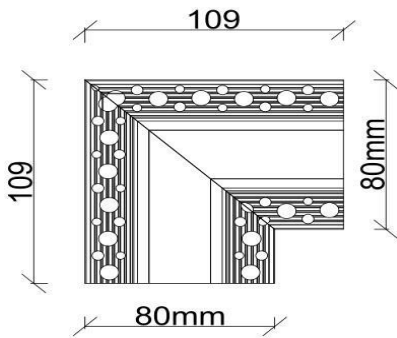

L

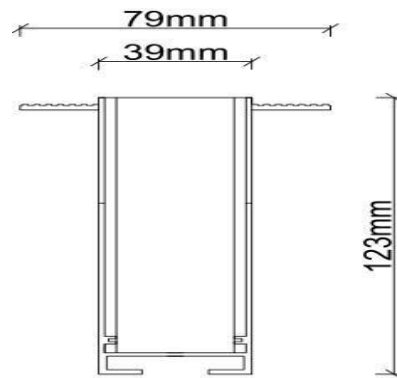

Inner

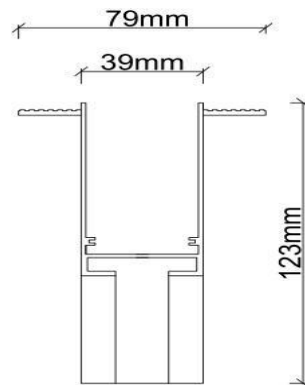
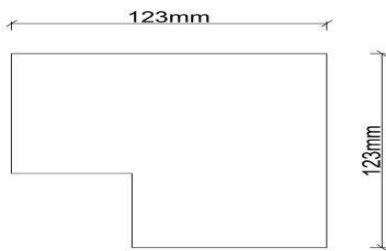

Outer

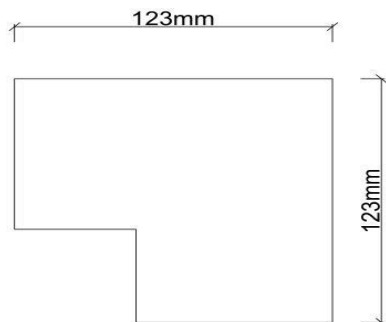

Data Sheet

DESCRIPTION



Recessed kit

Recessed kit for recessed installation

Pendant kit for pendant installation

Track Connector for connecting the profile and corner



Pendant kit



Track Connector

IP20

TECHNICAL DRAWINGS

Recessed kit

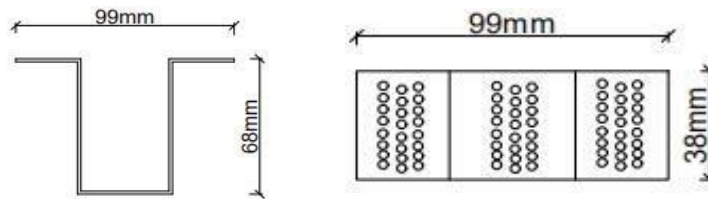

Pendant kit

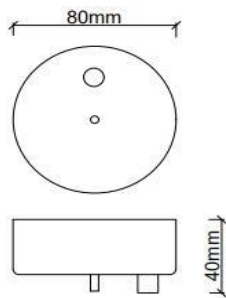

Track Connector

